

GlasStile GSS

Motorised Entrance Gate for Internal Installation

Technical Specification

Drive:	Motorised
Orientation:	Pass Left or Pass Right
Materials:	<p>Rotor Column: 220mm dia 304 Grade Grained Stainless Steel (EN 10088-2 Grade 1J/2J).</p> <p>Rotor Wing: 10mm thick clear toughened frameless Glass panel giving a max. 1000mm clear opening.</p>
Function:	Passage in both directions, electronically controllable.
Method of Operation:	On receiving a signal from the access control system or pushbutton, the unit will unlock and drive through 90 degrees away from signal direction. Should the wing meet any resistance it will stop and nudge forward. If obstruction continues the unit will alarm and free wheel. An Auto Reset will re-establish control
Power Failure:	<p>In the event of an emergency or isolation of power supply, unit will fail-safe i.e. rotor would freely turn in both directions.</p> <p>Fire Alarm – Input facility available for voltage free contact supplied by others to effect fail safe state.</p>
Interface:	Potential-free contact provided by either a cardreader or pushbutton input. Cardreader inhibit and reset output signals available as standard.
Power Supply:	115/230 Volts AC 50/60 Hz
Power Rating:	80 VA per Walkway
Logic Voltage:	24 Volt DC
Installation Details:	GlasStile GSS range is delivered kit form i.e. Wing and Rotor which may require lifting gear for off loading. Approximate weight 75 kg



Product Description

The GlasStile GSS from our Regulate range is an alternative approach to flow control.

The subtle design offers a minimal presence and easily integrates into any environment and complements our other security products as a disabled gate.

Users include

- Government
- Retail
- Finance
- Telecommunications
- Information Technology
- Banking
- Publishing
- Leisure
- Petrochemical
- Education

Regulate



Models Available

GlasStile S Motorised Entrance Gate

- Model GSS 1000mm clear opening.

Standard Materials

Rotor cladding and casework material choice

- 304 Grade Polished Stainless Steel, Ref: GM Type 3
- 304 Grade Grained Stainless Steel, Ref: GM Type 2
- CZ108 Polished Brass
- CZ108 Grained Brass

Standard Accessories and Optional Extras

Alternative Materials, Finishes and Custom Design

- Refer to Gunnebo Entrance Control Ltd for specific material design requirements.

Alternative Wing

- Selection of different glass panels to suit available space.
- Smaller panels to create tandem operations
- Stainless Steel 'P' leaf open design.
- Stainless Steel 'P' leaf with infill bars.

Cardreader Mounting (Please refer to Gunnebo Entrance Control Ltd for feasibility)

- Cardreader Pedestals.

Battery Back Up System.

- Maintains all 24V control facilities for 500 operations or 4 hours whichever the sooner. Remotely located.

Push Button Control

- Simple console to control GlasStile GSS rotor release.
- Remote console to specific requirements
- Push Button Pedestal.

Hand held programmer

- Required to set up new installations.

Push bar

- Affixed to the top of the glass wing to match casework choice.

Installation Examples

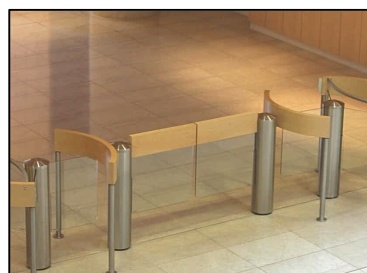

Site Preparation GlasStile GSS

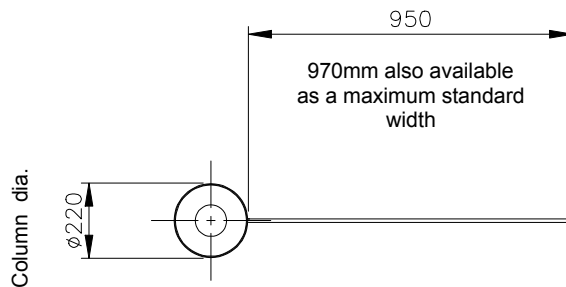
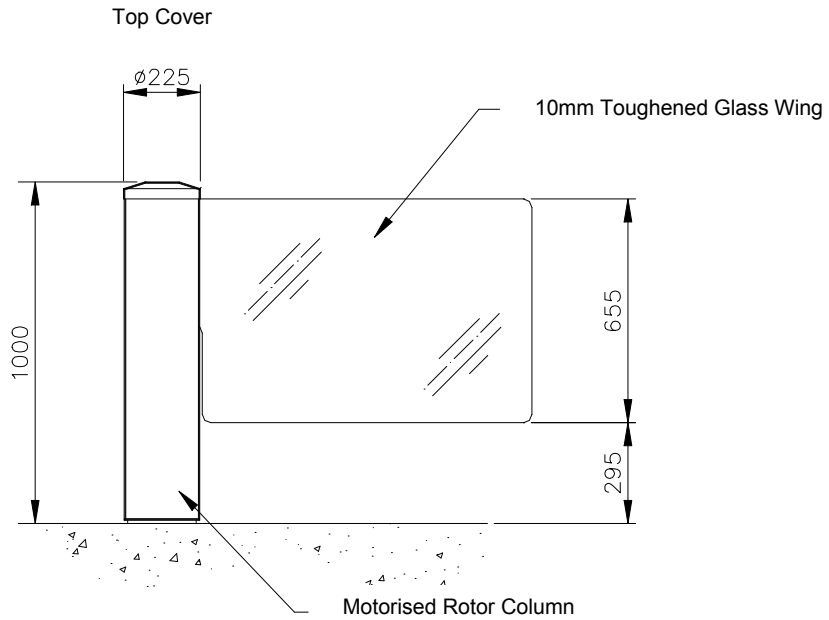

Concrete to BS 5328: 1997 specification, type ST5.
 Base to be flat and level to +/-5mm over footprint area.
 Rotor Column Base min 300 x 300 x 300mm

IMPORTANT

- Floor Anchors to be drilled during installation, 12mm dia. x 100mm deep.
- Any horizontal pipe or conduit runs below the GlasStile GSS must be at least 140mm

GUNNEBO

ENTRANCE CONTROL

United Kingdom

Gunnebo Entrance Control Ltd. Bellbrook Business Park, Uckfield, East Sussex, TN22 1QQ.
Tel +44 (0) 1825 761022 Fax +44 (0) 1825 763835

www.gunneboentrance.com

Note: In pursuit of its policy of continuous refinement and improvement, Gunnebo Entrance Control Ltd reserves the right to modify design and details.

A COMPANY WITHIN THE GUNNEBO GROUP

HEAD OFFICE SWEDEN

Gunnebo Entrance Control AB, 590 93 Gunnebo, Tel +46 (0) 490 890 00, Fax +46 (0) 490 23889

DENMARK Gunnebo Protection A/S
Division Entrance Control
Erhvervsparken 3, DK-4621 Gadstrup
Tel +45 46 19 14 66
Fax +45 46 19 14 55

FRANCE Gunnebo Entrance Control SARL
Zone d'Activites Le Mandinet,
20 Rue des Campanules
F-77185, Lognes
Tel +33 (0) 1 64 80 14 40
Fax +33 (0) 1 64 80 14 39

GERMANY Gunnebo Entrance Control GmbH
Diagonalstrasse 41, D-20537
Hamburg
Tel +49 (0) 40 47 11 30 0
Fax +49 (0) 40 47 11 30 79

HONG KONG Gunnebo Entrance Control
Room 2312, C.C. Wu Building,
302-308 Hennessy Road, Wanchai.
Tel +852 2882 8337
Fax +852 2523 7880

ITALY Gunnebo Entrance Control SpA
Via A Volta 15 - IT 38015
Lavis (TN)
Tel +39 0461 248 900
Fax +39 0461 248 999

NORWAY Gunnebo Troax A/S
Division Entrance Control
Postboks 179, Kalbakken N-0903, Oslo
Tel +47 22 80 42 00
Fax +47 22 80 42 01

SPAIN Gunnebo Entrance Control SL
BBC, Comte d'Urgel 143, lola 08036,
Barcelona
Tel +34 93 452 59 56
Fax +34 93 451 56 53

SWEDEN Gunnebo Entrance Control
Box 500, Kumla Gardsvag 33F, 145 63
Norsborg
Tel +46 (0)8 53 17 15 75
Fax +46 (0) 8 53 18 85 39

UNITED KINGDOM Gunnebo Entrance Control Ltd
Bellbrook Business Park, Uckfield,
East Sussex, TN22 1QQ
Tel +44 (0) 1825 761022
Fax +44 (0) 1825 763835

USA Gunnebo Omega Inc
535 Getty Court, Suite F, Benicia
California, CA 94510
Tel +1 707 748 0885
Fax +1 707 745 6020