

# SpeedStile FL

## SpeedStile FL

### Flap Panel Gate for Internal Installation

#### Technical Specifications

<b>Unit Dimensions:</b>	Casework Length	Normally Closed – 75.59" (Lid Length 76.22")
	Casework Height	39.37"
	Casework Width	7.08"
	Clear Walkway	Narrow – 21.65" Wide – 36"
	Panel Height	34.64"
<b>Drive:</b>	Motorised	
<b>Materials:</b>	Top:	#4 Grained Stainless Steel
	Front:	#4 Grained Stainless Steel
	Side Cladding:	#4 Grained Stainless Steel
	Inlay:	Plexiglas Black Finish
	Rotor:	#4 Grained Stainless Steel Shaft
	Wing Panels:	0.39" Tempered Glass bonded into rotor
	Center Sections:	0.39" Tempered Glass
<b>Function:</b>	Passage in both directions electronically controlled. The SpeedStile is available in Normally Closed (NC) mode and it will only open on acceptance of an authorised signal.	
<b>Drive Mechanism:</b>	The panels are moved by two 90 degree bevel gears. The drive unit is a DC motor connected to a worm reduction gear and an angular sensor. A microprocessor control system guarantees the precise movement and positioning of the wings.  The opening and closing speeds of the Panels are adjustable. A safety photocell prevents the panels from closing on an obstruction and allows a complete passage with luggage. Should the normal panel operation be stopped by an obstruction, the controlling logic detects an abnormal condition and activates a series of operation aimed at protecting the user.  The panels are mechanically locked in the closed position and cannot be forced open.	
<b>Method of Operation:</b>	On receiving a signal from the access control system, or push button, the panels will open. If an unauthorised person tries to tailgate or attempts to enter from the opposite direction, the system detects the unauthorised passage and activates the in-built alarm system.  Presence sensing is achieved by 10 No. infrared sensors on each cabinet.	
<b>Status Lights:</b>	50mm diameter LED display Status Lights flush mounted within the SpeedStile lid top face. The Green badge symbol is continuously illuminated indicating passage is available. Upon authorisation, a Green Arrow will illuminate in the direction of passage authorisation whilst in the opposite direction a Red Cross symbol will illuminate to indicate the unit is not available for use or is already in use.	
<b>Power Failure:</b>	In the event of a power failure, the panels will remain in the current position and they can be pushed freely in the exit or evacuation direction. The wings can also be powered to the open position with the use of its internal Battery Backup system (Option).	
<b>Fire Alarm:</b>	Input facility is available for voltage free contact supplied by others to effect fail state.	
<b>Additional Interface</b>	RS232 and RS 485 Serial Interface available on the master logic panel	
<b>Power Supply:</b>	110VAC 50Hz/60Hz	
<b>Power Rating:</b>	Stand by	Less than 0.50 AMP
	In operation	Upto 8.0 AMP

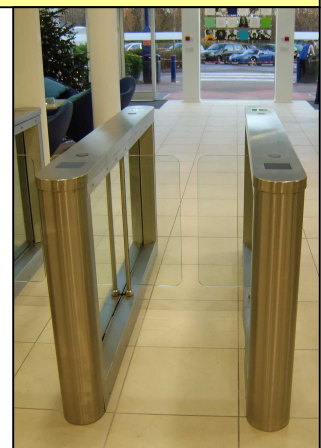

#### Product Description

This speed gate provides a high design finish together with effective security features.

New concept. Large range of possible personalisation and options. Proven technology for fast and reliable operation.

The small footprint makes the SpeedStile FL the preferred solution for site where high security and flowrate in a limited space is required. Its Glass and stainless steel design allows it to incorporate into most lobby and minimise the barrier effect.

#### Users include

- Government
- Retail
- Finance
- Telecommunications
- Information Technology
- Banking
- Publishing
- Leisure
- Petrochemical
- Education

<b>Logic Voltage:</b>	24Vac and 30Vac	
<b>Operating Temperature:</b>	+5 to +40°C	
<b>Installation Details:</b>	The SpeedStile is delivered as a fully assembled unit and may require lifting gear off loading.	
<b>Approximate Weight:</b>	NC - Left or Right cabinet (LH or RH)	297lbs per cabinet
	NC - Centre cabinet (CU)	330lbs per cabinet

**Accessories and Optional Extras**

**Alternative Materials, Finishes and Custom Design**

- Refer to Gunnebo for specific material design requirements.
- Top lid material options.

**Cardreader Mounting** (Please refer to Gunnebo Competence Center Entrance Control Inc for feasibility)

- Integration of customer supplied readers into the SpeedStile Top and Front inlays.
- Cardreader Pedestals.

**Battery Back Up**

- On power failure, the battery backup option will allow the wings to open (or close), stop and become inactive. The wings will remain in this position until power is restored.

**Push Button Control**

- Simple console to control SpeedStile wing release.
- Remote console to specific requirements.
- Casework mounted push button.

**Traffic Flow Control**

- LED Way Mode Indicator - Switching Red cross and Green arrow to indicate the unit is available for use
- Remote switching of unit for Traffic Flow.

**Counting**

- LCD Counter

**Status Light User Instructions**

**Normal Use**



**Green Card** (Rest mode)

- Present personal security card to the reader mounted upon the unit for authorization. Wait for the Green Arrow to illuminate and the barrier to open.



**Green Arrow** (Authorized use or designated free passage)

- Proceed through the unit.

**Note** - For FREE PASSAGE configuration, authorization is not required and is normally used for EXIT only.



**Red Cross** (Unit in use or no passage)

- Wait until the passageway has been vacated and either the Green Card or Green Arrow to illuminate.

## Alarm Conditions

### Flashing Red Cross and Audible Alarm (Fraudulent condition)



- This alarm mode will be activated via the following scenarios;

Passageway is already in use and a second person has attempted to follow through without authorisation. (Tailgating) OR Passageway is currently in use and you do not have right of passage.

- **Do not panic.**
- Vacate the passageway.
- Wait for the flashing Red Cross to stop flashing and the Audible Alarm to cease.
- Wait for the Green Arrow to illuminate to indicate who has the right of passage.

### Flashing Green Card (Incorrect use mode)



- **Do not panic.**
- Remain in the walkway and present personal security card to the reader mounted on the unit for authorisation.
- Authorisation of passage will cancel the alarm condition.

### Flashing Green Arrow (Emergency / Fire Exit)



- **Do not panic.**
- 
- There is FREE PASSAGE to evacuate through the gate

## Flow Rates

Reader Device	Number per minute
Insertion type	30
Insertion type with PIN code keypad	20
Swipe type	25
Swipe type with PIN code keypad	20
Proximity 'Hands Free'	40

- Please note the figures are approximate and must be confirmed with Gunnebo Competence Centre Entrance Control. Figures quoted are for one person per complete passage per walkway and per minute. It is assumed the access control authorisation response is instantaneous. Flow rates will increase with multiple passage use.

## Installation Examples



**2L/3P SPEEDSTILE FL**  
**CARD IN/FREE EXIT**  
 (OTHER OPTIONS & CONFIGS AVAILABLE)

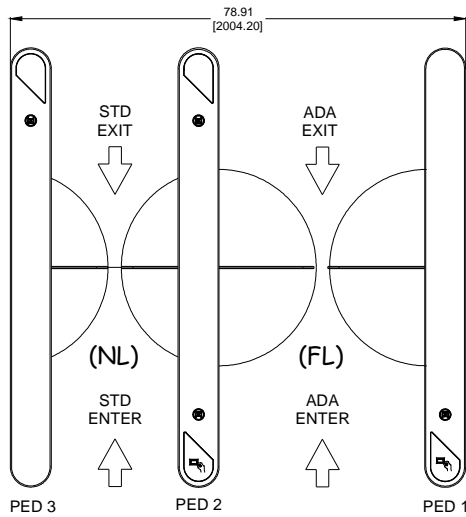
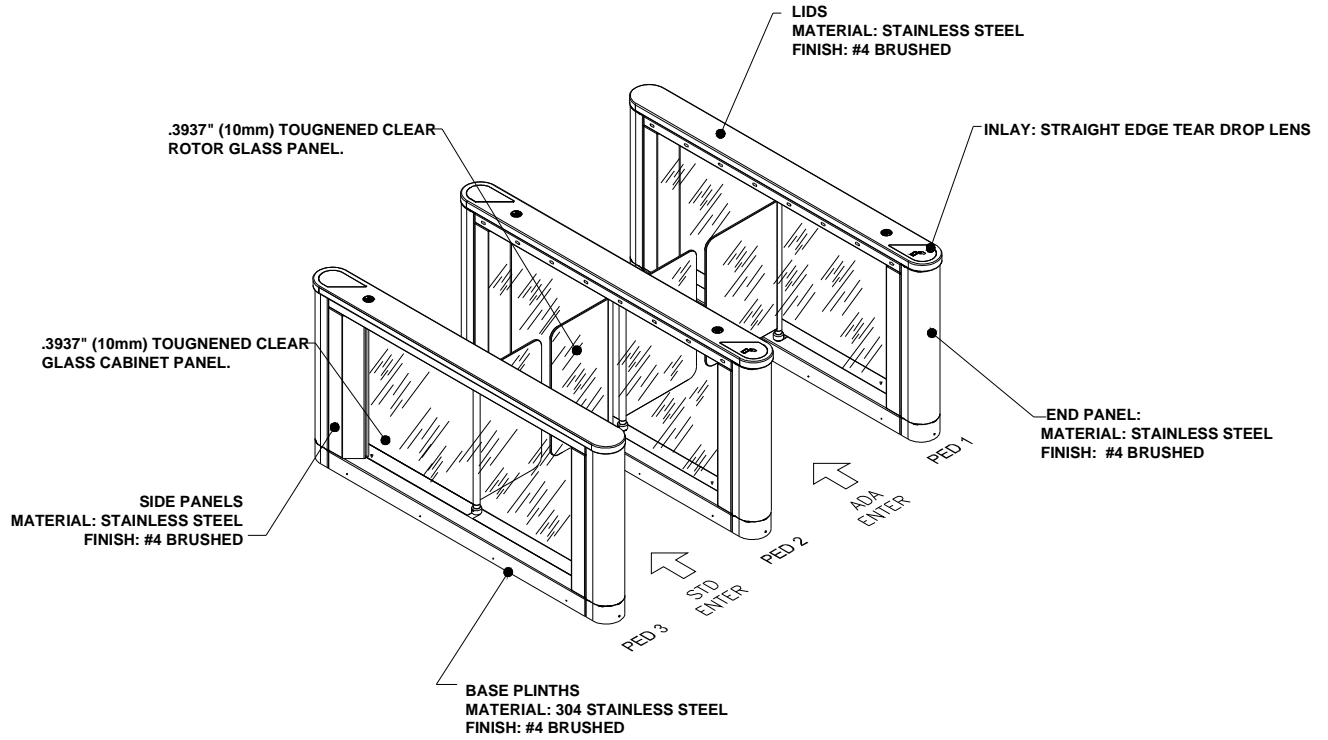

**PLAN VIEW**

**2L/3P SPEEDSTILE FL**  
**CARD IN/FREE EXIT**  
 (OTHER OPTIONS & CONFIGS AVAILABLE)

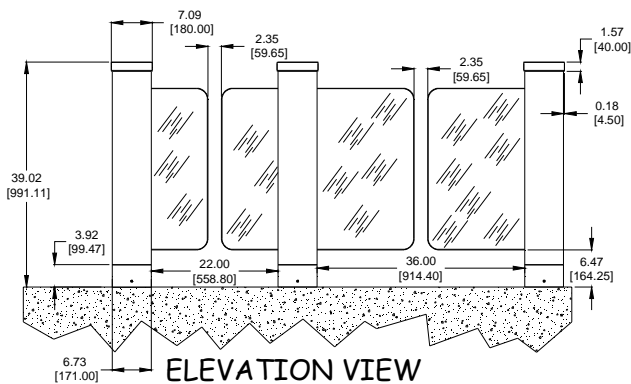

**ELEVATION VIEW**

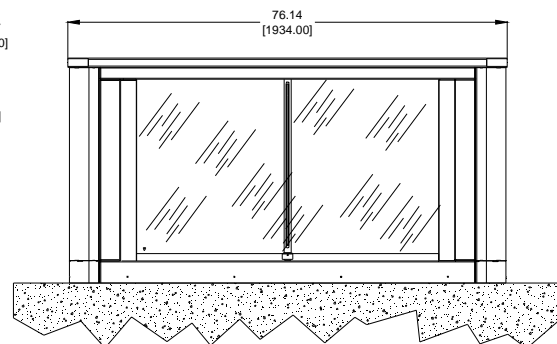

**RIGHT SIDE VIEW**

# MOUNTING TEMPLATE

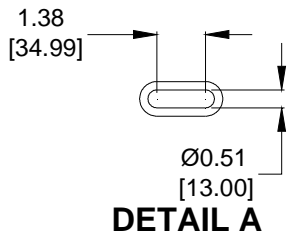
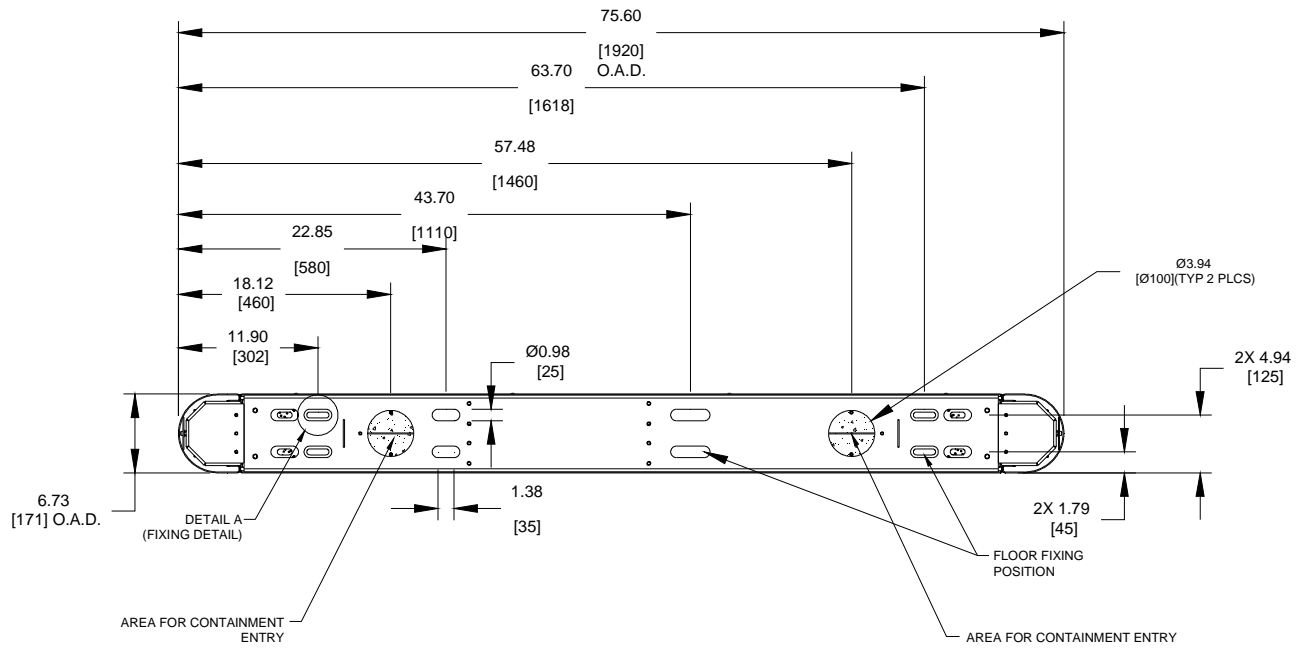

**IMPORTANT**

- Any conduit runs must be 5.5" below FFL.

For further information please contact:



Gunnebo Entrance Control Inc. 535 Getty Court, Suite F, Benicia, CA 94510  
Phone 707-748-0885 Fax 707-745-6020  
E-mail [info.us@gunnebo.com](mailto:info.us@gunnebo.com)  
Web [www.gunnebo.us](http://www.gunnebo.us)



**A COMPANY WITHIN THE GUNNEBO GROUP**

HEAD OFFICE SWEDEN  
Gunnebo AB, Box 5181, SE-402 26 Goteborg, SWEDEN. Tel +46-31 83 68 00, Fax +46-31 83 68 10

**[www.gunnebo.com](http://www.gunnebo.com)**

Note: In pursuit of its policy of continuous refinement and improvement, Gunnebo Entrance Control Ltd reserves the right to modify design and details.